



Engineering, Architecture, Consulting, Quality and Services

ENGLISH

 **Eptisa**
GRUPO **EP**



TOGETHER, a great team



Engineering, Architecture, Consulting, Quality and Services

Eptisa was set up as an independent engineering company in 1956, thereby counting as the longest established company in its sector in Spain.

Since its establishment, **Eptisa** has collaborated with both the Public Administration and private companies, and as one of the major Spanish companies in the fields of engineering, architecture and services, **Eptisa** has taken part in the economic development and technological modernisation of the country.

In 1966, **Eptisa** began to operate abroad and since then, projects have been completed in a vast number of countries in Europe, Latin America and Africa.

The ongoing development of **Eptisa** gave rise to the **EP Group**, a corporate body of engineering and service companies that constitutes one of the most important Spanish groups in these fields. The structure of the Group is such that it can approach the works undertaken from a multidisciplinary and innovative perspective, always seeking the optimum solution for the customers' requirements.

The **EP Group** consists of twelve companies specialising in engineering and engineering services. The shareholder is the company MAYA, belonging to a group of employees.

By the end of 2002, the EP Group transferred its shares in the remaining engineering companies within the Group to **Eptisa, Servicios de Ingeniería S.A.**, as part of a strategic approach focusing on management integration by sectors. **Eptisa** now heads the integrated management of the EP Group's activities within the sector of engineering.

Following this unification process, the new organisation integrates the four subsidiaries two subsidiaries in Catalonia, The Basque Country, and two dedicated to International Activities and Technologies of Control and Measurement.

Eptisa's mission is to offer services based on its engineering experience, constituting a company with a strong presence throughout Spain and maintaining an important position on the international market. In 2006, an income of 115,6 million Euros was reported, including the results of four companies that have become part of Eptisa in 2004.

In order to achieve its mission, Eptisa employs a multi-disciplinary team of more than 1300 employees, whose purpose is to fulfil customers' requirements through applying the principles of quality and respect for the environment, and who are all equipped with highly advanced technological resources to carry out their task.





human resources



People are **Eptisa's** main resource. More than 1300 employees – including over 650 university graduates - work together to a common end: Serving customers through the quality of their work.

Our teams are qualified in an extremely wide range of technical, scientific, economic and social disciplines: Engineers, architects, economists, geologists, chemists, biologists, experts in communication/information technologies, etc...

The integrity of our human resources enables us to take a global and multidisciplinary approach to our tasks and design the most suitable solution for each individual problem.



material resources



Eptisa employees are equipped with the most modern material resources: Our network of installations covers an office area of more than 12.000 m², and we have a fleet of more than 200 vehicles.

Additionally, the Eptisa network of construction laboratories has certified installations in the provinces of Barcelona, Burgos, Ciudad Real, Gerona, Guadalajara, La Coruña, León, Lérida, Madrid, Málaga, Pontevedra, Salamanca, Seville, Tarragona, Toledo, Valladolid and Vizcaya.

Furthermore, there are also a number of in situ laboratory facilities available for installation, whenever required.

The Agroalimentary and Enviromental Laboratory, located in Vilaboa (La Coruña) and certified by ENAC and the Spanish Ministry of Environment, offers analysis, test and trial services in the fields of agriculture, food and environmental issues.

Eptisa possesses the very latest information and communication technology resources, which provide first class technical support for developing the company's activities.





geographical areas of activity



Eptisa carries out its activities throughout Spain, and the organisation is decentralised with a head office in Madrid and a number of regional and local offices strategically distributed throughout the country's Autonomous Regions. This ensures an enhanced physical proximity to all our clients as well as an in-depth knowledge of the local area.

This decentralised structure allows each office to act as an independent organisation when it comes to dealing with projects, ensuring that employees are in touch with the local community and its features. Each office is backed by a high-quality framework of technical support.

Eptisa has been involved in international projects since 1966 and has carried out works in more than 20 countries in Europe, Latin America and Africa.

The company Eptisa Proyectos Internacionales, S.A. was set up in 1997 with a view to develop activities within the foreign market. Now, Eptisa has subsidiaries in Argentina, Brazil, Colombia, Chile and Romania, as well as permanent delegations in Belgrade and Brussels.

international experience



Projects

Algeria, Argentina, Belize, Bolivia, Bosnia and Herzegovina, Brazil, Bulgaria, Chile, Colombia, Costa Rica, Cuba, Dominican Republic, Ecuador, Egypt, El Salvador, French Guyana, Guatemala, Honduras, Hungary, Jordan, Mauritania, Mexico, Morocco, Namibia, Nicaragua, Palestine, Panama, Paraguay, Peru, Philippines, Romania, Russia, Serbia and Montenegro, Slovakian Republic, Slovenia, Syria, Tunisia, Turkey, Uruguay and Venezuela.





services

Eptisa's services range from preliminary studies to the undertaking of complete projects and include the following activities, among others:

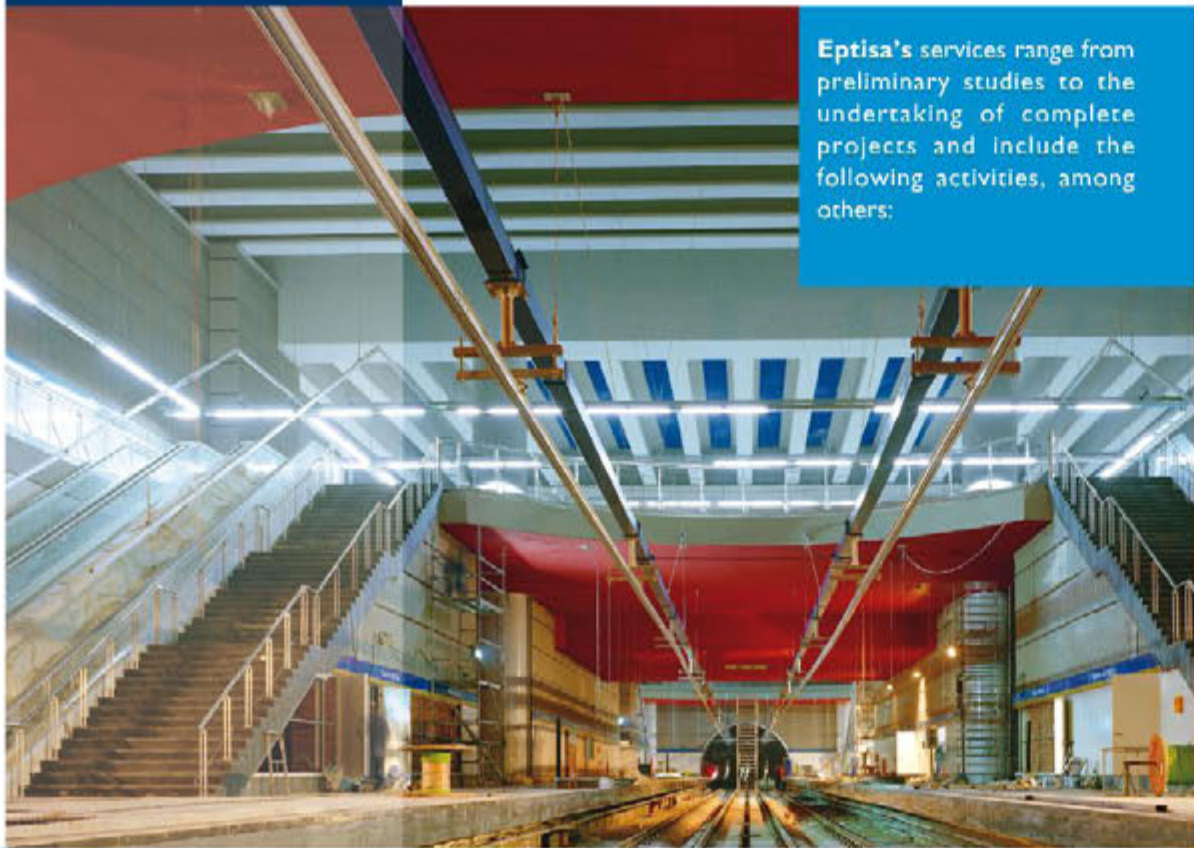

Engineering, Architecture, Consulting, Quality and Services



areas of activity

Eptisa has developed its activities within numerous areas of the engineering and services sectors:





Preliminary studies

Informative studies.

Master plans.

Technically- and/or economically-oriented feasibility studies.

Investment estimates.

Preliminary, basic and bidding projects.

Complete development of engineering and architectural projects.

Performance projects.

Detailed engineering.

Specifications.

Equipment supply and management.

Works and workshop plans.

Measurements and estimates.

Quality assurance.

Assistance in purchasing

Technical and administrative specifications.

Comparison of offers.

Contract management.

Drawing up and formalising contracts.

Order placement, activation and inspection.

Planning

Budget control

Supervision, control and management of works

Consulting and training



Engineering

Architecture

Project management

Supervision and control of works

Industry and energy

Environment

Quality consultancy and management

Development cooperation

Integration of technologies for measurements and control



engineering



Eptisa's work in various fields is endorsed by 50 years of experience in engineering – the company's original area of activity – and the use of the most modern technologies has enabled the company to strengthen its leadership by combining experience and innovation. Nowadays, there is a clear move towards a stronger involvement in projects that possess a high degree of added value.

These activities have evolved within the Area of Projects and Consultancy, consisting of the fields of Infrastructure of Transport and Town Planning, Hydraulics Works, and Environment and Territorial Development.

Infrastructure for surface transport.

Airport and air transport engineering.

Ports and coasts.

Town planning.

Geotechnics.

Mining.

Planning for and managing water resources.

Hydraulic infrastructure for supply, sanitation, hydroelectric power and irrigation.

Dam and reservoir safety.

Waste storage.

Geology and hydrogeology.

Agronomy and forestry engineering.

Expropriations, inventories, property and land registry, land boundaries, demarcation and enclosure.



architecture and project management



The need for an overall concept, considering the design and construction of single buildings or industrial plants, gave rise to the development of the Construction Management activity within **Eptisa**. This concept unites activities ranging from preliminary studies, drafts and projects, through management of contracts and works commissioning, all the way to accepting the responsibility for complete projects involving major investments. Market developments brought about the setting up of the Area of Architecture, Engineering and Project Management, whose activities have included major works in the fields of construction and industry.

This Area's activities include the following:

General consultancy

- Feasibility Studies.
- Needs analysis.
- Legal advice.
- Investment studies.
- Property consultancy.
- Functional studies.
- Evaluation engineering.

Construction management

- Contract and purchase management.
- Planning of deadlines and investments.
- Activity coordination.
- Management and supervision of works.
- Cost control and deadline management.
- Quality assurance.
- Commissioning.

Project management

- Architecture.
- Civil engineering.
- Installation engineering.
- Environmental engineering.
- Infrastructure.
- The environment. Environmentally friendly housing.
- Process management.

Operational management consultancy

- Auditing.
- Pathology and restoration studies.
- Operation and maintenance consultancy.
- Energy consultancy.
- Communication.
- Safety.
- Management of working environments.

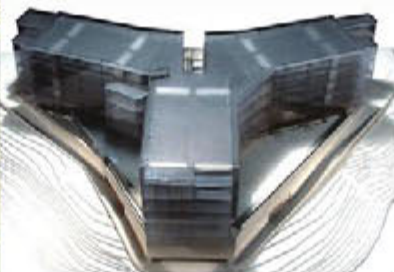

industry and energy



From the outset, **Eptisa** has taken part in the development of the fields of industry and energy management.

Initially specialising in hydroelectric power plant engineering, the company has diversified into other markets and is now involved in a large number of projects within the power and energy transformation sector.

Current activities include:

Basic and detailed engineering.

General project planning.

Hydroelectric developments; large and small power plants.

Distribution systems within networks of distribution and commercialisation.

Pharmaceutical and cosmetic products.

Automotion.

Food engineering.

Logistics.

Management of waste and its environmental impact.

Re-adaptation of polluting industries.

Purchasing, order activation and inspection.



works supervision and quality control



Quality has been one of **Eptisa's** main concerns since the very beginning. The experience obtained in improving internal quality led to the setting up of the Works Supervision and Control Department, which provides external customers with the knowledge that has been acquired internally. At present, **Eptisa** is one of the main quality inspection and control firms operating on the Spanish market, involving not only civil works but also buildings and industry.

Works management, control and supervision.

Quality control.

Supervision of performance and reception of installations.

Technical and economic analysis of the feasibility of civil and industrial works.

Construction pathology studies.

Inspection, control and monitoring of civil works.

Certified construction laboratories.

Quality control and assurance body.

Technical audits.

Agroalimentary and environmental laboratory.

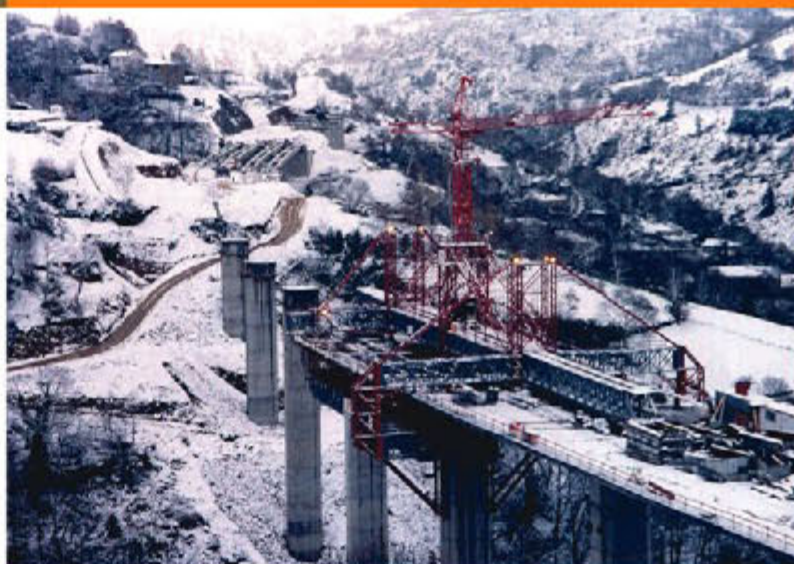



the environment



Natural resources

Hydrogeology.

Geology.

Placement of contaminating tanks.

Risk analysis.

Geographical information system (GIS) for management of natural resources and the environment.

Environmental management

Treatment of contaminated soil.

Extraction and treatment systems for contaminated groundwater treatment.

Industrial wastewater treatment.

Optimisation of processes for reducing the amount of wastewater produced.

Waste recycling and production studies.

Environmental impact assessment for infrastructures and industries.

Recovery and restoration of industrial sites and mining works.

Conservation of natural areas.

Environmental recovery.

Environmental audits.

Assistance in environmental emergencies.

Integrated contamination prevention and control.

Eptisa's Environmental Department offers consultancy and management services with a view to finding optimum solutions to environmental problems, utilising its great experience to set up institutional enhancement programmes in the fields of legislation, management and environmental control through its Natural Resources and Environmental Management Areas. These include the following:



development cooperation



Reconstruction and risk prevention.

Institutional strengthening.

Technical cooperation.

Methodology in planning and management.

Creation of training centres.

Planning professional training.

Technical and IT-based trainings.

Training and development of human resources.

Management policies for Public Administration.

Health and hygiene.

Rural development.

Urban development.

Infrastructure.

Water and drainage.

Environment.



Based on more than thirty years of experience in the execution of projects outside Spain, the Area of International Projects occupies a prominent place within **Eptisa**, bringing in around fifteen percent of sales.

Apart from offering and managing Eptisa's services abroad, this Area has also developed its own range of services specifically focusing on consultancy with regards to institutional and administrative development and strengthening. These activities are in high demand, and the Eptisa International Projects Area has been carrying them out in numerous countries for more than ten years.





quality consultancy and management



Eptisa developing the **Grupo EP** brought about the need to overcome certain internal management and organisational problems that are inherent to this type of development. The Consultancy Department came into existence as a result of this, and this area is now capable of providing a response to the need for management control in any communications and information technology environment. Furthermore, the need to apply quality system to the companies within the Grupo EP led to the development of the Area of Quality Assurance, which then spread to other companies outside the Group, in turn applying the methods developed by ourselves in an increasingly rigorous way.

This Area has gradually evolved to the extent that it currently acts in a works consultancy capacity in the widest sense of the term.

Company organisation and management.

Strategic plans.

Socio-economic and market analyses.

Feasibility and profitability studies.

Transport planning. Intermodality.

Logistics consultancy.

Commercial studies.

Tourism consultancy.

Design, implementation and upkeep of quality systems.

Training in Quality.

Quality consultancy in accordance with the EFQM model.

Communication technology consultancy: hardware and software strategies.

Development of communication technology applications.

Management and updating of alphanumeric and graphic data.

Communication technology system for management control.





integration of control and measurement technologies

Since its foundation as a subsidiary of **Eptisa** in 1982, the Engineering of Instrumentation and Control (IIC) Area has incorporated those technologies relating to data acquisition, instrumentation, control and communications systems, as well as the integration of control systems for start-to-end projects, into the company. This includes managing all those phases requiring such systems, from project management to start-up, covering such stages as design, manufacturing, supplies management, installation, start-up, employee training and follow-up maintenance.

These steps require a vast knowledge of the technologies involved in each process, especially in terms of sensors, data acquisition equipment, systems of information transmission, specific software for data acquisition and management, as well as the techniques related to the electrical and mechanical hardware design behind all those technologies.

Furthermore, this Area has the needed management capacity to control all accessory works, civil works, complete assemblies, special operations, etc., which together form a complete project from beginning to end.

This Area offers tailor-made engineering for all those parameters involved in the process of civil, environmental and industrial construction works, including acquisition, transfer and management, thereby offering services that complement the traditional activities of engineering, consulting or technical assistance.

Control of civil works and mining.

Environmental control.

Industrial automatization.

Electronic equipment under specification.

Equipment for control laboratories.

Services for the power sector.

Facilities of security and communications.

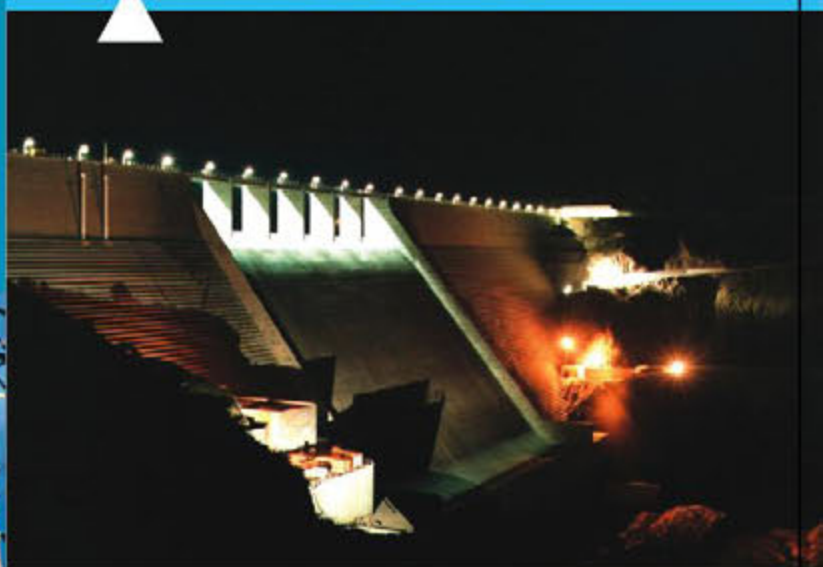



Serving society since 1956

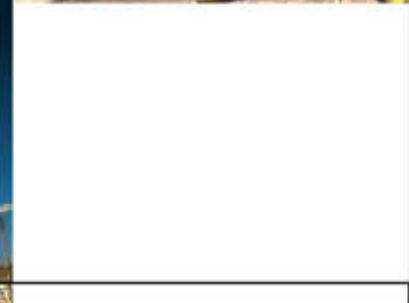



Engineering, Architecture, Consulting, Quality and Services



Eptisa
GRUPO EP



Eptisa Servicios de Ingeniería, S.A.

Arapiles, 14 28015 Madrid Tel. +34 91 594 95 00 Fax +34 91 446 55 46 www.eptisa.es

Eptisa Enginyeria i Serveis, S.A.

Via Augusta, 158 - 7ª Planta 08006 Barcelona

Tel. +34 93 362 45 90 Fax +34 93 362 45 91

Eptisa Cinsa Ingeniería y Calidad, S.A.

Avda. Iparraguirre, 82 48940 Lejona - Vizcaya

Tel. +34 944 80 62 25 Fax +34 944 64 93 21

Eptisa Proyectos Internacionales, S.A.

Princesa, 3 - 6ª Planta 28008 Madrid

Tel. +34 91 559 51 52 Fax +34 91 547 39 34

Ingeniería de Instrumentación y Control, S.A. (IIC)

Princesa, 3 - 6ª Planta 28008 Madrid

Tel. +34 91 559 22 59 Fax +34 91 547 98 51